

EOCR-DZ [T]

Multi-functional relay that has an earth fault protection function with the zero phase current detection method

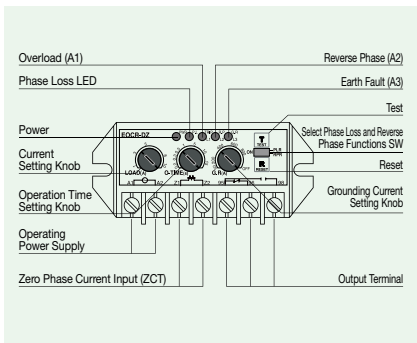

- Built-in MCU (Microprocessor Control Unit)
- Over current/phase loss/reverse phase/unbalance/locked rotor/earth fault protection
- Earth fault protection with zero phase current detection method
- Wide current setting range
- Automatic calculation of start delay time
- Operation and trip cause display
- Definite operation characteristics
- Manual (instant)/electrical (remote) reset
- Strong environmental resistance
- Super energy-saver
- No-voltage release/Fail-safe operation → N type
- DZ: Hole type, DZT: Terminal type



EOCR-DZ

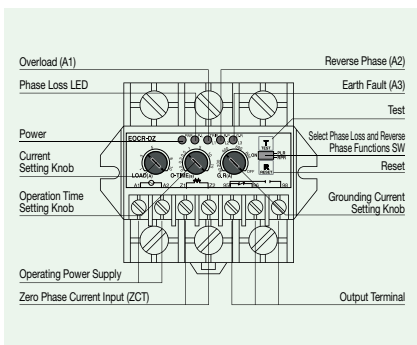

EOCR-DZT

Protection Function

Protected Items	Operation Time
Over Current	O-TIME
Phase Loss	Within 4 sec
Reverse Phase	0.1 sec
Unbalance	8 sec
Locked Rotor	After D-TIME when $I > I_s \times 3$
Earth Fault	0.5 sec

Trip cause check - 5LED

	PWR	PL	OL	RP	GR
Power supply (during operation)	●	○	○	○	○
Over Current	○	○	●	○	○
Earth Fault	○	○	○	○	●
Reverse Phase	○	○	○	●	○
Phase Loss	○	L1 Phase Loss	○	●	○
		L2 Phase Loss	○	●	○
		L3 Phase Loss	○	○	●
Unbalance	○	●-○	○	○	●
Locked Rotor	○	○	○-●	○	○

※ LED Display: ON(●), OFF(○), ON-OFF(●-○)

Specifications

Model		EOCR-DZ (T)	
Current Setting	Type	Current Setting Range	Earth Fault Current Setting Range
	5	0.5~6A	0.05~0.8A
	10	1.0~10A	0.05~0.8A
	60	5.0~60A	0.05~0.8A
	60~600	Combine 05Type and an external CT for use	0.05~0.8A
Time Setting	Start Delay	D-TIME	Automatic Calculation (up to 60 sec)
	Operation Time	O-TIME	0.2~15 sec
Reset		Manual (instant)/electrical (remote) reset	
Operation Time Characteristic		Definite	
Operation Display		5LED	
Error Tolerance	Current	±10%	
	Time	±10%	
Operating Power Supply	Voltage	110	AC85~150V, 50/60Hz
	Capacity	220	AC180~260V, 50/60Hz
Auxiliary Contact	State	1-SPDT	AC250V/3A resistive load
	Resistance	R	Normally de-energized (regardless of power supply: 95-96 Close, 95-98 Open)
		N	Normally energized (after power is supplied: 95-96 Open, 95-98 Close)
Insulation	Resistance	Between case and circuit	10MΩ or higher with a DC500V Megger
	Withstanding Voltage	Between case and circuit	2.0kV power frequency for 1 min
		Between contacts	1.0kV power frequency for 1 min
		Between circuits	2.0kV power frequency for 1 min
Usage Environment	Temperature	For operation	-20~60°C
	Humidity	For storage	-30~80°C
Attachment		EOCR-DZ	Panel
		EOCR-DZT	35mm DIN Rail/Panel

EOCR-DZ[T]

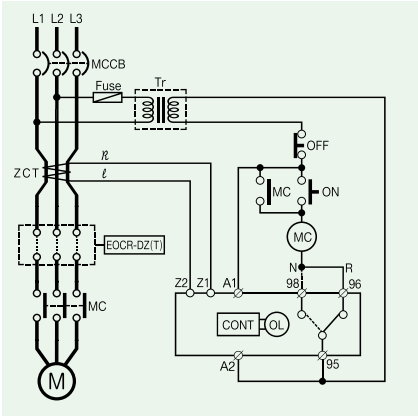

※ “N” (Fail safe) Type converts 96 to open and 95 to 98 to close when operating power is supplied to A1 and A2 (or L1 and L2).
 ※For ZCT terminal, it must be used without ground connection.

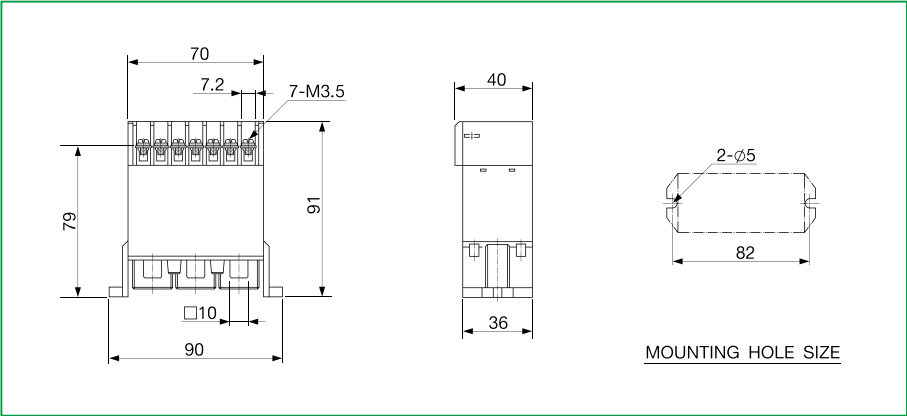

EOCR-DZ (Hole Type)

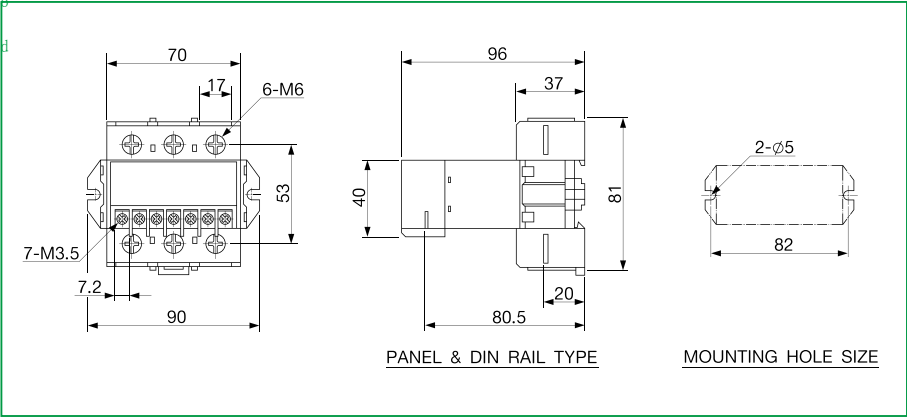

EOCR-DZT (Terminal Type)